

LT Threaded Conduit Bodies with Steel Cover & Gasket - Gray

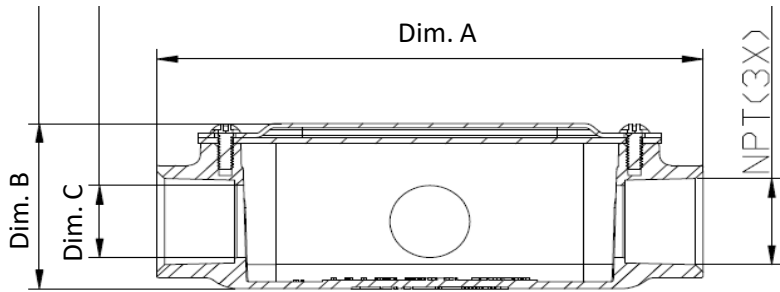

Item #	Size (NPT)	Dim. A	Dim. B	Dim. C	Dim. D
LT050	1/2"	4.72	1.59	0.61	2.02
LT075	3/4"	5.51	1.86	0.81	2.30
LT100	1"	6.45	2.12	1.04	2.68
LT125	1-1/4"	8.34	2.73	1.37	3.52
LT150	1-1/2"	8.34	2.73	1.60	3.52
LT200	2"	10.55	3.64	2.05	4.27
LT250	2-1/2"	13.46	4.29	2.46	5.88
LT300	3"	13.46	4.84	3.06	5.88
LT350	3-1/2"	16.10	5.90	3.54	7.65
LT400	4"	16.10	5.90	4.01	7.65

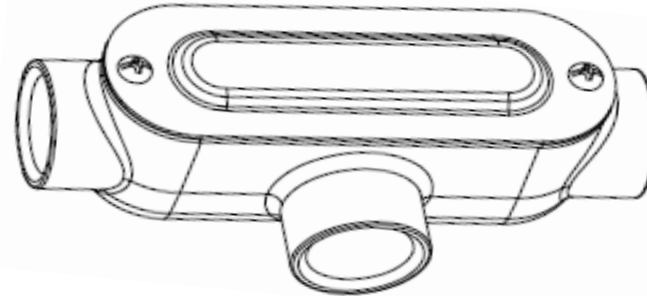
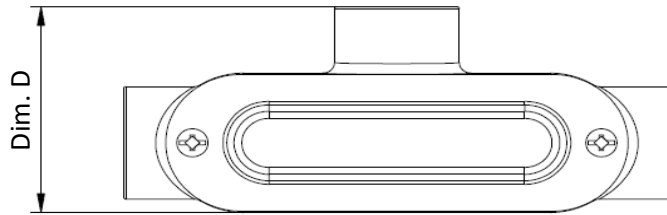

TOLERANCE UNLESS OTHERWISE SPECIFIED: X.X +/- 0.2 .XX +/- 0.1

BODY MATERIAL	Aluminum Die Cast
COVER MATERIAL	Steel
CERTIFICATIONS:	UL 514A (QCIT)
MARKING:	cULus
CERT#	E362604



Superflex Ltd.
400 S 2nd Street
Elizabeth NJ 07206

PART NO	REV DATE
REV: 1	8/1/2023